

# \$188,000 - 9348 105 Avenue, Edmonton

MLS® #E4380515

**\$188,000**

0 Bedroom, 0.00 Bathroom,  
Land Commercial on 0.00 Acres

Boyle Street, Edmonton, AB

VACANT LOT. 10.1M X 37.2M OR 33 ft x 122 ft. or 4,026 sq. ft. Central location; close to all amenities City Centre has to offer. Close to residential Highrise buildings. THIS IS A CORNER LOT; AS THE LOT 9352 IS PART OF THE CITY OF EDMONTON ROADWAY FOR THEIR SHOPS. Walking distance to River Valley and trials; also to City Centre which includes Roger Place, Ice District.

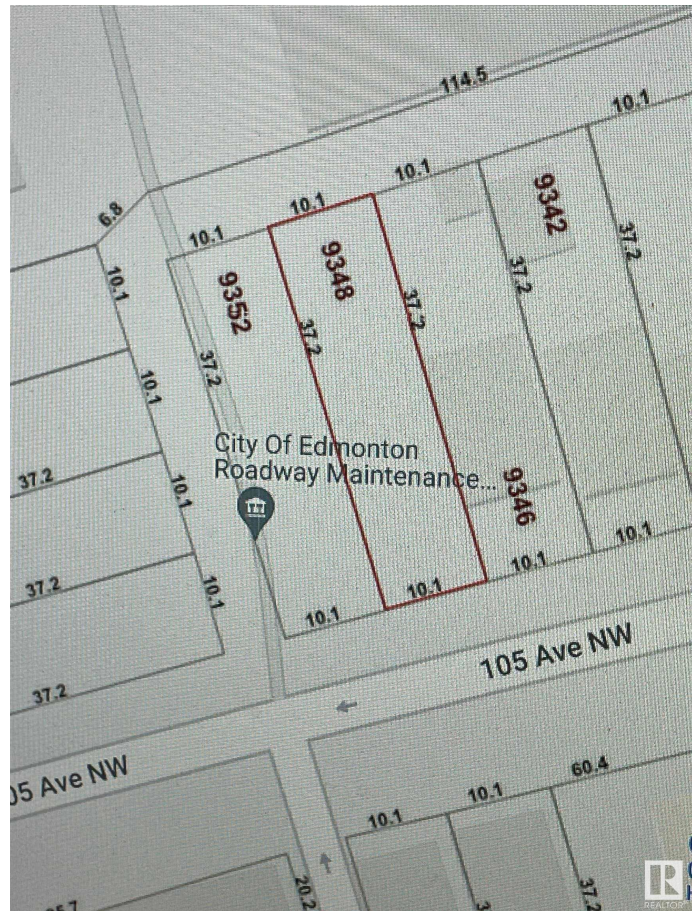

## Essential Information

MLS® #	E4380515
Price	\$188,000
Bathrooms	0.00
Acres	0.00
Type	Land Commercial
Status	Active

## Community Information

Address	9348 105 Avenue
Area	Edmonton
Subdivision	Boyle Street
City	Edmonton
County	ALBERTA
Province	AB
Postal Code	T5H 0J6

## Additional Information

Date Listed April 5th, 2024  
Days on Market 364  
Zoning Zone 13



DATA IS DEEMED RELIABLE BUT IS NOT GUARANTEED ACCURATE BY THE REALTORS<sup>®</sup> ASSOCIATION OF EDMONTON. COPYRIGHT 2025 BY THE REALTORS<sup>®</sup> ASSOCIATION OF EDMONTON. ALL RIGHTS RESERVED. Trademarks are owned or controlled by the Canadian Real Estate Association (CREA) and licensed to real estate professionals who are members of CREA (REALTOR<sup>®</sup>/REALTORS<sup>®</sup>) and/or the quality of services they provide (MLS<sup>®</sup>, Multiple Listing Service<sup>®</sup>)

Listing information last updated on April 4th, 2025 at 6:47am MDT

